

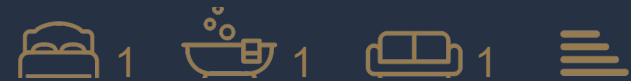

68 Jenner Court St. Georges Road, Cheltenham, GL50 3ER

£800 PCM





£800 PCM

68 Jenner Court St. Georges Road

Cheltenham, GL50 3ER

- RETIREMENT PROPERTY
- ON SITE STAFF 24 HOUR
- COMMUNAL GARDENS
- HOLDING DEPOSIT : £184.00
- COUNCIL TAX BAND : B
- READY NOW
- EMERGENCY ALARM SYSTEM
- PARKING
- TENANCY DEPOSIT : £923.00
- COUNCIL: CHELTENHAM



HMT Sales & Lettings are delighted to offer to let, this 1 bed retirement property available for the over 65's.

Located on St Georges Road, Jenner Court is ideally situated close to the town centre. Parking is available within the complex but there is also a bus stop conveniently located outside the complex that takes you straight into town.

The apartment is located on the third floor that can be accessed via the lifts for ease.

Within the apartment there is a Lounge which leads into the Kitchen. There is a large double Bedroom with built in wardrobe as well as a Bathroom





Included are staff on site 24 hours a day, an emergency alarm system for peace of mind in case first aid is required and one hour of domestic assistance is also included per week. There is a communal Lounge which is perfect if you would like to socialise with the other residents or the gardens if you would like to get outside to look at the plants and enjoy the sun. There is also a guest suite which is available to hire if family/friends come to stay.

Directions





Floor Plans

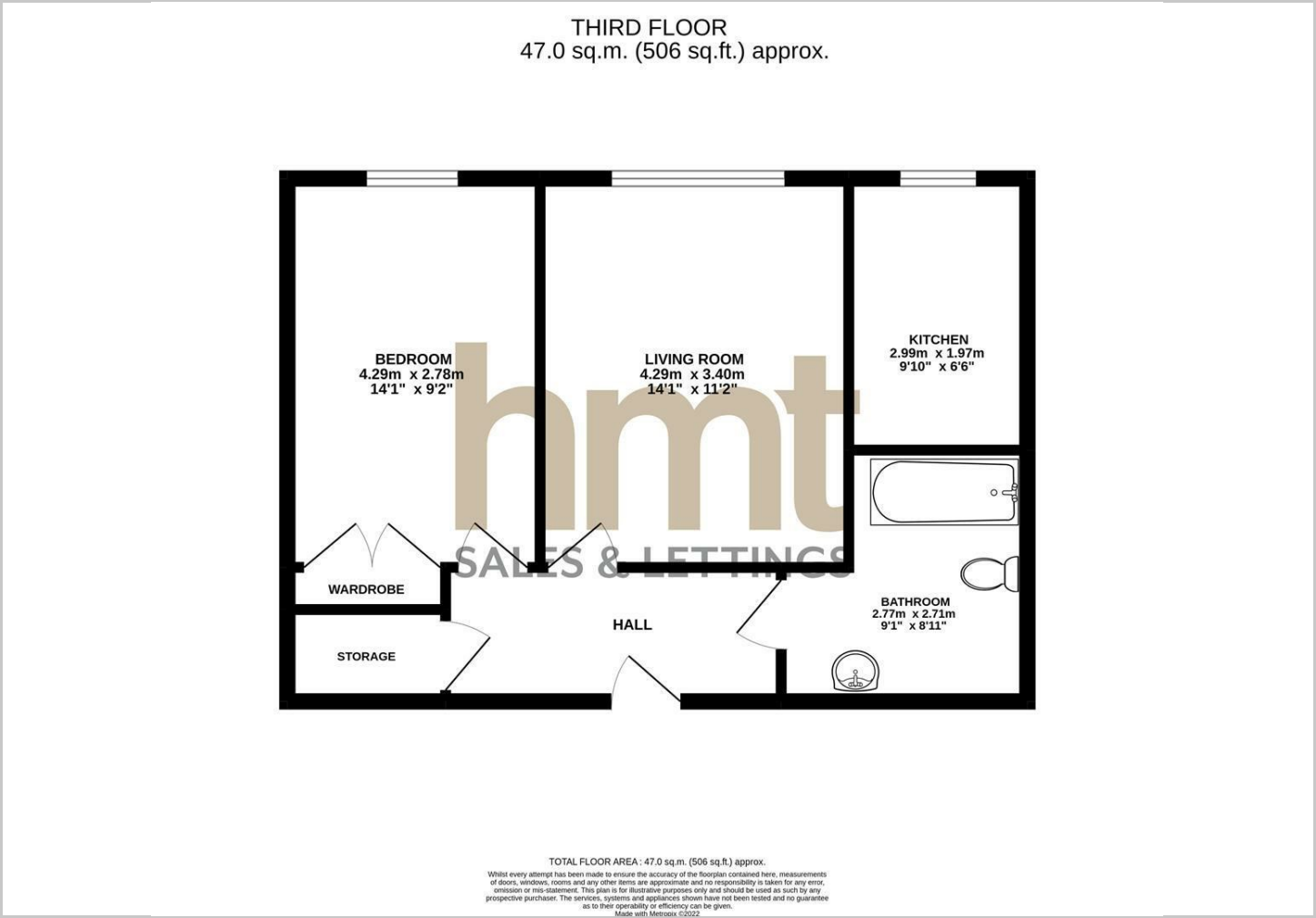

Viewing

Please contact our HMT Office on 01242 521322 if you wish to arrange a viewing appointment for this property or require further information.

The particulars are set out as a general outline only for the guidance of intended purchasers or lessees, and do not constitute, any part of a contract. Nothing in these particulars shall be deemed to be a statement that the property is in good structural condition or otherwise nor that any of the services, appliances, equipment or facilities are in good working order. Purchasers should satisfy themselves of this prior to purchasing.

2 Crescent Terrace, Cheltenham, Gloucestershire, GL50 3PE
Tel: 01242 521322 Email: info@hmt.co.uk www.hmt.co.uk

Location Map



Energy Performance Graph

